

GROUND FLOOR

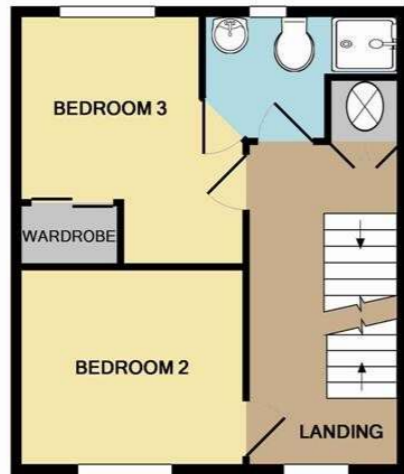

1ST FLOOR

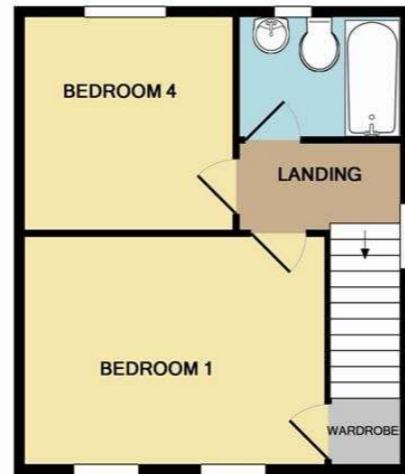

2ND FLOOR

SHEARS DRIVE, AMESBURY - BASNET LETTINGS
 Measurements are approximate. Not to scale. Illustrative purposes only
 Made with Metropix ©2013

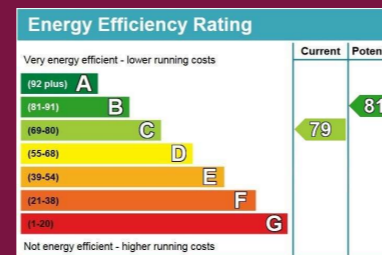

82 Shears Drive, Amesbury

£325,000 Freehold

Salisbury, SP4 7XY

We are pleased to offer to market this spacious four bedroom townhouse set in a sought after location in Amesbury. The well presented accommodation consists of: entrance hallway, downstairs cloakroom, sitting room / study, kitchen / breakfast room, four double bedrooms, shower room and a family bathroom. The property also benefits from an enclosed rear garden and a garage. Being sold with no forward chain, viewing is highly recommended to appreciate the accommodation on offer.

IMPORTANT: We would like to inform prospective purchasers that these sales particulars have been prepared as a general guide only. A detailed survey has not been carried out, nor the services, appliances and fittings tested. Room sizes should not be relied upon for furnishing purposes and are approximate. If floorplans are included they are for guidance and illustration purposes only and may not be to scale. If there are any important matters likely to affect your decision to buy, please contact us before viewing the property.





Overview

- FOUR BEDROOM TOWNHOUSE
- SOUGHT AFTER LOCATION
- TWO BATHROOMS
- DOWNSTAIRS CLOAKROOM
- MODERN KITCHEN / DINER OPENING ONTO THE GARDEN
- SOLD WITH NO FORWARD CHAIN
- GAS CENTRAL HEATING
- DOUBLE GLAZING
- GARAGE AND PARKING
- FRONT AND REAR GARDENS



Entrance Hallway

Downstairs Cloakroom

Lounge

Kitchen / Dining Room

Bedroom One

Bedroom Two

Bedroom Three

Bedroom Four

Family Bathroom

Bathroom

Council Tax Band: 'E'

Agent's notes - Draft particulars

Sales Disclaimer (OVM)

These particulars are believed to be correct and have been verified by or on behalf of the Vendor. However, any interested party will satisfy themselves as to their accuracy and as to any other matter regarding the Property or its location or proximity to other features or facilities which is of specific importance to them. Distances and areas are only approximate and unless otherwise stated fixtures contents and fittings are not included in the sale. Prospective purchasers are always advised to commission a full inspection and structural survey of the Property before deciding to proceed with a purchase.